

OTL29200011

REVISIONS

LTR	DESCRIPTION	DATE	APPROVED
-	ECN 10186, RELEASE	6/2/00	KT 6/2/00

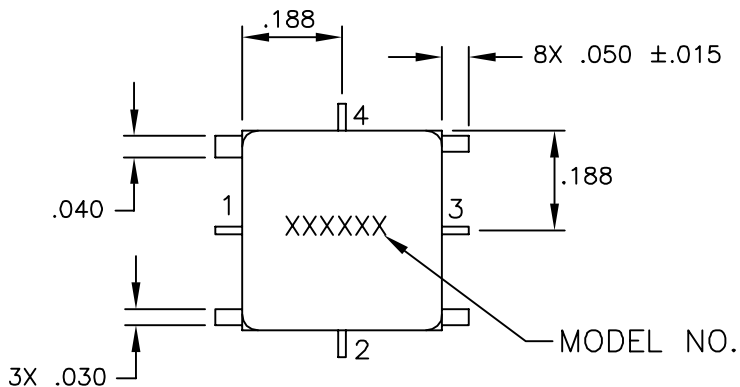

- PIN 1 - INPUT
- PIN 2 - GROUND (AMPLIFIERS)  
CONTROL VOLTAGE (ATTENUATORS)
- PIN 3 - OUTPUT
- PIN 4 - +DC

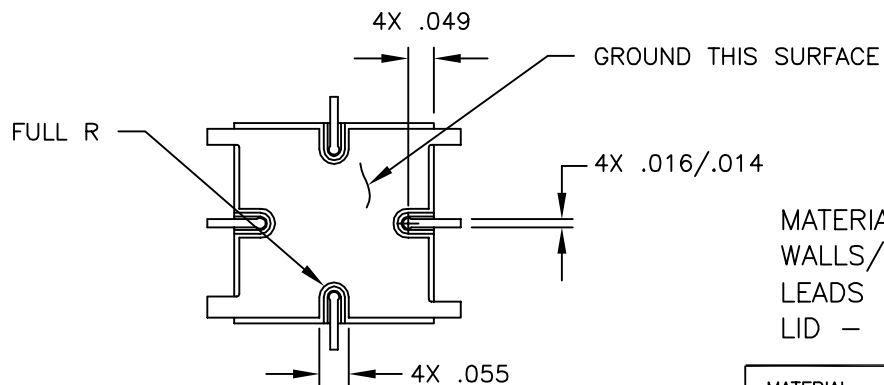
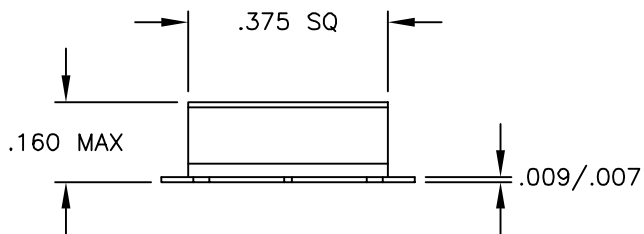

MATERIAL:  
WALLS/BASE - CERAMIC/KOVAR  
LEADS - KOVAR  
LID - KOVAR

FINISH:  
WALLS/BASE - GOLD/NICKEL PLATING  
LEADS - GOLD/NICKEL PLATING  
LID - NICKEL PLATING



**CAUTION**  
THIS ASSEMBLY CONTAINS PARTS SENSITIVE TO DAMAGE BY ELECTRO-STATIC DISCHARGE (ESD). USE ESD PRECAUTIONARY PROCEDURES WHEN TOUCHING, REMOVING OR INSERTING.

MATERIAL: SEE ABOVE	DRAWN ADAM SIDLE 4/17/02	DATE	2707 BLACK LAKE PLACE, PHILADELPHIA PA. 19154
	CHECKED	DATE	
FINISH: SEE ABOVE	ENGINEERING ARR 6/2/00	DATE	OUTLINE DRAWING SM11
DIMENSIONSTIONS: INCHES	MANUFACTURING	DATE	
TOLERANCE	QUALITY KT 6/2/00	DATE	CODE IDENT NO.
DEC. .XX +/- .01			60979
.XXX +/- .002			OTL 29200011
ANG .X' +/- 3'			K:\ENGINEER\ACLTWIN\OTL\29200011
			SHT 1 OF 1